

# ARCOLA BUS SALES

A Div. of Arcola Sales & Service Corp.

51 Kero Road

Carlstadt, N.J. 07072-2601

Tel: (201) 507-8500 Fax: (201) 507-5372

www.ArcolaSales.com

\*\*\*\*\*  
\*\*\*\*\* **BID PROPOSAL** \*\*\*\*\*  
\*\*\*\*\*

Date: 02 Mar 2011  
Ref No.: 32754-MID854-HS

## SUBMITTED TO:

*Mr. Patrick Moran Bus. Adm.  
Middlesex Regional Ed. Serv. Comm.  
1660 Stelton Road  
Piscataway, New Jersey 08854*

## VEHICLE TYPE:

New/Used: N	Item 4 - Type B Wheelchair Bus (D.R.W)
Year: 2012	6 Row, 6.0l Gas, 12,300 Gvwr, 159"Wb
Body Manuf: Collins	1 Wheelchair + 20 Ambulatory
Chassis: Chevrolet	

## DETAILED DESCRIPTION:

Item	Qn
C/A	1
CORE CHEV GRAND 6SEC WCREAR 09	1
Chevy / GMC Mobility Rebate	1
PRICE ADJ LEVEL2 CGX6WR	1
CHEVY DRW 159" 12300 6.0G AC/T	1
GM GOVT PRICE CONCESSION	1
* FREIGHT FROM KS	1
AC 40K INWALL CARR CHEV CM2	1
BUMPER 10" DRW EXH UNDER/SIDE	1
ENDCAPS GX FGLASS COL WARN LT	1
RUBRAILS FLOOR LEVEL GX6	1
RUBRAILS SEAT LEVEL GX6WR	1
RUBRAILS SKIRT GX6 AC	1
* UNDERCOAT - FULL UNDERBODY N.J.	1
EXHAUST CHEV X6 UNDER/THRU	1
DOOR CONTROL MANUAL, 5 SWITCH MAX S/GX	1
DOOR ENTR GLASS TEMP H/S/GX	1
GRABRAIL LH ENTR 42IN BARR MNT	1
GRABRAIL RH ENTR 30IN	1
DOOR REAR EGRESS RHHINGE SX/GX	1
REAR DOOR HINGE 1PC STAINLESS	1
REAR DOOR LATCH 1PT	1
WNDW REAR DOOR LOWER TEMP CLR	1
WNDW REAR DOOR UPPER TEMP CLR	1
2 DOME LIGHTS OVR LIFT AREA	1
DOOR W/C SINGLE LEAF 42X64	1
FLOODLIGHT ON LIFT DOOR	1

Item	Qn
RED PILOT LIFT DOOR FLASHING	1
WINDOW LIFT DOOR TEMP 32%	1
BATTERY NO BOX CHEV GAS	1
SUBFLOOR GX6 1/2 PLY	1
FLOOR COVER BLK OFFSET GX6	1
STEP TREAD GX RIBBD BLK/WHT	1
HEATER 60K WALL MOUNT CHEV GAS	1
HEATER SHUT OFF VALVE-CABLE OP	1
INT PANELS LOWER EMB GALV X6WR	1
INT PANELS UPPER GX6WR SMOOTH	1
PADDING PKG GX5WR/GX6WR GRY FB	1
DOVE LTS THRU IGNITION	1
MONITOR STOP LIGHT/DSH MOUNTED	1
MONITOR 8LT AEROFLASH	1
PAINTED BLACK BORDER WARN LT	1
VISORS 8LT	1
WARNING SYS 8LT MSTR/WARN/CNCL	1
WARNING LAMPS 8LT HALOGEN SURF	1
CLEARANCE LIGHTS LED - LOW PROFILE	1
REVERSE LED WITH REAR DR OPEN	1
STOP/TAIL 7IN RED	1
STOP/TAIL/TURN 4IN FLUSH LED	1
TURN SIGNAL MIDBODY AMB FLUSH	1
TURN SIGNAL REAR 7IN AMBER	1
MIRROR INTERIOR 6X16 FLAT	1
MIRRORS, REAR & CROSS - ROSCO CS/CG	1
PAINT BODY EXT CHEV SX/GX YELL	1
PAINT ROOF WHITE	1
PAINT RUBRAILS NJ STYLE BLACK	1
LTRG/EMERG DR ARROW RED	1
EGRESS WINDOW SIGNAGE FMVSS/Y	2
BARRIER HB LH 45 MED GRAY FB	1
BARRIER HB RH 30 MED GRAY FB	1
* BACK-UP ALARM	1
WRECKING BAR 30IN	1
STOP ARM INCND TS REFL 6000	1
HATCH TRAN 1975-004-111 1IN Y	2
CROSS ARM CHEV SPEC 68600 POLY	1
ENDCAP "SCHOOL BUS" REFLECTIVE	1
* INSTALL SEAT TO TRACK	8
SEAT HB LH 45 ASY MED GRAY FB	4
SEAT HB RH 30 ASY MED GRAY FB	4
SEAT BELT 60IN BLACK CBC	8
SEAT BELT 60IN GRAY CBC	8
SEAT BELT 60IN RED CBC	4
INSTALL OEM HUB CAPS CHEV	1
LIFT INTERLOCK CHEV INTERMOTIV	1
ACCESSIBILITY SYMBOL 6" X 6"	1
TRACK ABOVE WINDOW LH X6	1
TRACK ABOVE WINDOW RH X6WR	1
TRACK SEAT + W/C LH CGX6WR	1
TRACK SEAT + W/C RH X6WR	1
KINEDYNE 4-PT BELT W/BAG	1
LIFT BRAUN NCL917IB ADA/403	1
WINDOW SASH TEMP 32% BLACK	8
WNDW EXIT LHVERT TEMP 32% BLK	1

Item	Qn
WNDW EXIT RHVERT TEMP 32% BLK	1
WNDWS REAR BODY SX/GX TEMP CLR	1
FIRE SUPPRESSION SYSTEM ENGINE	1
FIRE EXT 5LB 10ABC FRONT MNT	1
FIRST AID KIT #202-126 NJ	1
TRIANGLE WARNING REFLECTORS 3	1
SEAT BELT CUTTER	1
LETTERBELT 5IN DECAL	1
NUMBER BELT 5IN DECAL	1
"BATTERY" 2IN DECAL	1
PAINT CHASSIS GRILL gray	1
Fire Blanket	1

Pre-Delivery Prep

Delivery

NJ School Inspection FEE (pd to State)

NJ School Inspection - Mech & Lift (plus NJISV)

\*\* Documentation Charge - Clerical Exp

\*\* DMV Messenger Charge

Title, N.J. w/ lien

Plates, NJ School S1 (>16p) - DMV Fee

**PRICE PER VEHICLE: \$ 48,990.00**

**PROPOSED BY:**

***House Account***

*Account Manager*

*Phone Extension: 0*

*email: Sales@ArcolaSales.com*

290.37  
BUMPER TO BUMPER

SEATING CONFIGURATION BASED ON ENGINEERING ESTIMATES. FINISH BUILT BUS WEIGHTS MAY REQUIRE REDUCTION IN CAPACITY.

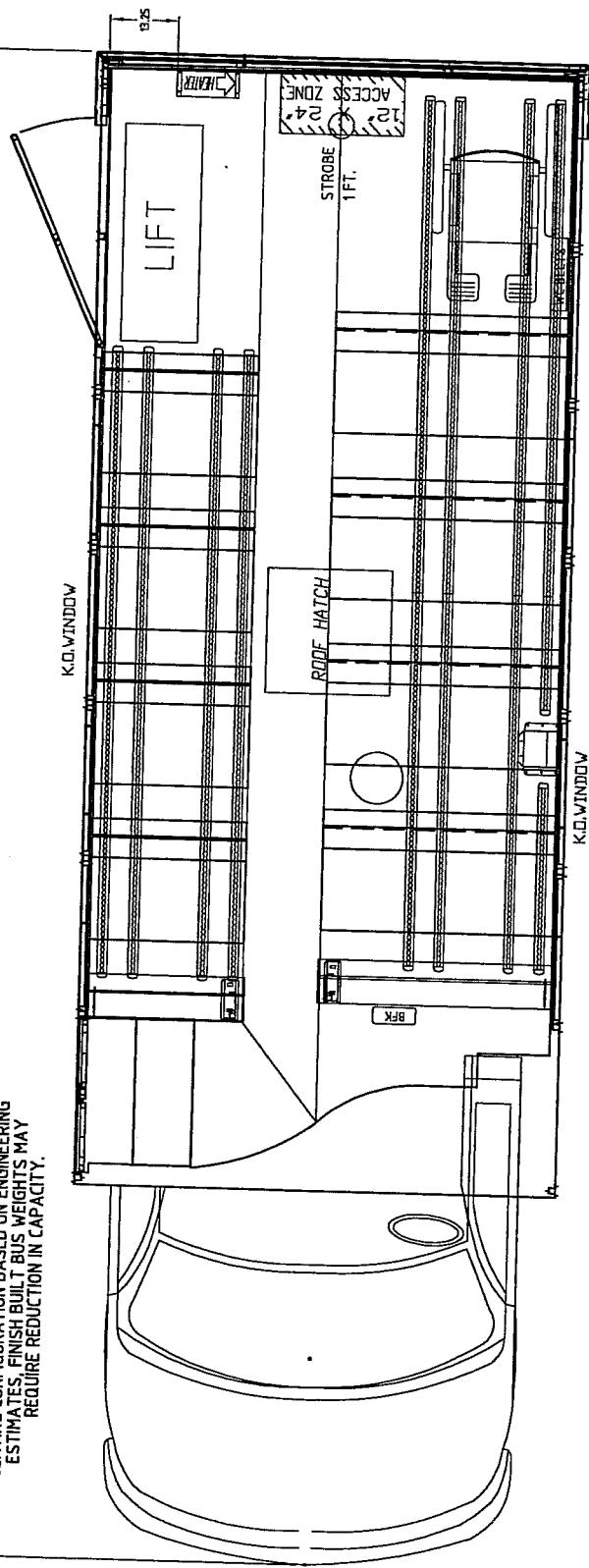

CGX6WR

ARCOLA

- 20 Passengers & 1 WheelChair Position
- 4 30 inch RH Seats at 26 inch Hip to Knee
- 4 45 inch LH Seats at 25/28 inch Hip to Knee

Approved By: *[Signature]*

Date: 1/24/11



TITLE CHEVY GRAND SB

COLLINS BUS CORP.  
P.O. BOX 2946  
HUTCHINSON, KS.  
67504-2946  
FORM: F-7.3.06 REVISION 0

THIS DRAWING AND ALL  
INFORMATION THEREON  
IS THE PROPERTY OF  
COLLINS IND. INC.

DRAWN BY

DEL

DATE

01/10/11

DRAWING NO.

48561-66CGX6WR-13G